

RoHS Compliant Customer Drawing

REV.	ECN NO.	DESCRIPTION	DATE	DESIGN

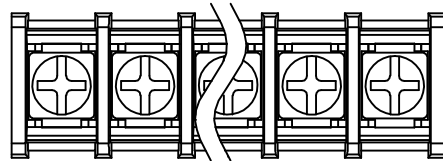

- 材质及电镀 (Material)
 整件 (Housing): PA66, UL94V-0
 端子 (Terminal): 黄铜, 0.7% 镀锡 (Brass, Tin Plated)
 螺丝 (Screw): M3, 钢, 镀锌 (Steel, Ni-Plated)
- 电气性能 (Electrical)
 额定电压 (Rated Voltage): 300V
 额定电流 (Rated Current): 20A
 绝缘电阻 (Insulation Resistance): 500MQ/DC500V
 耐电压 (Withstanding Voltage): AC2000V/Min
- 机械性能 (Mechanical)
 温度范围 (Temperature Range): -40℃ ~ +105℃
 适用线径 (Wire Range): 22-14AWG
 最大扭矩值 (Max. Torque Value): 0.5N.m 4.4Lb.in

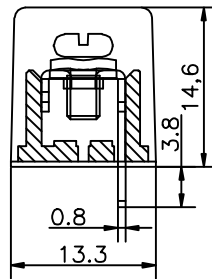
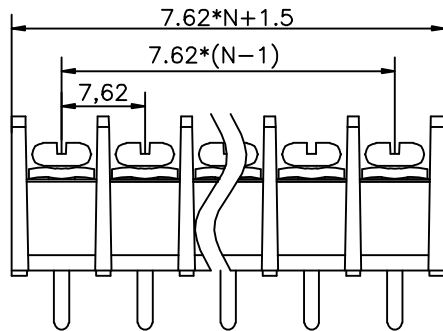

订购方式/HOW TO ORDER

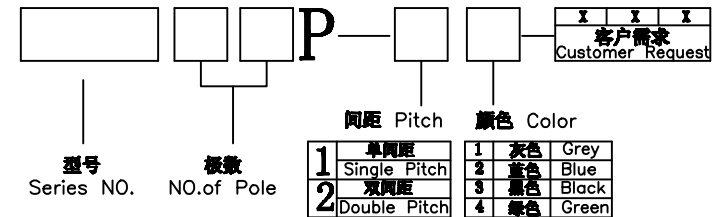

CONTACT WITH US:
 TEL: +86-574-63505128 FAX: +86-574-63532183
 E-Mail: sales@nbmax.com.cn Website: www.nbmax.com.cn

N=No. of contacts

公差一览表				NINGBO MKX ELECTRONIC TECHNOLOGY CO.,LTD			
TOLERANCE UNLESS OTHERWISE				NINGBO MKX ELECTRONIC TECHNOLOGY CO.,LTD			
X.	±0.25	X°	±5°	单位	mm	制图	陈冬梅
.X	±0.20	.X°	±2°	UNITS		DRAWING	
.XX	±0.15	.XX°	±1°	角法	⊕	设计	顾兴伟
.XXX	±0.02	.XXX°	±0.5°	VIEW		DESIGN	
日期	2012.07.10	版本	A0	比例	1:1	审核	
DATE		VER		SCALE		CHEK	
				原图		批准	
				APPD			
						产品名称	MX25S-7.62
						型号	
						产品料号	MX25S-7.62
						PART NO.	
						图号	MX25S-7.62-0A
						DRAW NO.	