

8 7 6 5 4 3 2 1

| REVISION RECORD |      |             |      |      |
|-----------------|------|-------------|------|------|
| REV             | ECN. | DESCRIPTION | DRFT | DATE |
|                 |      |             |      |      |

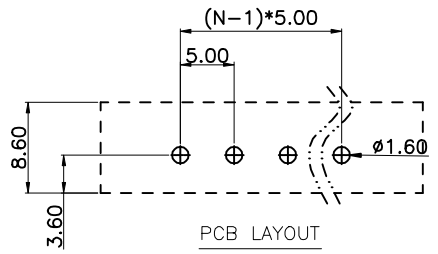
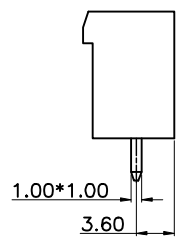
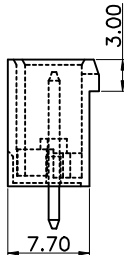
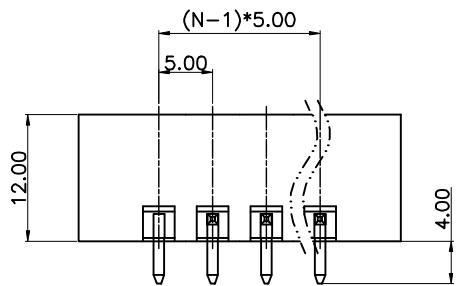
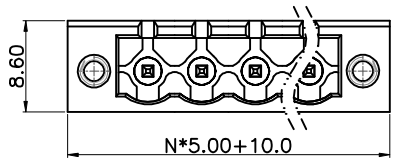

**NOTE 1:**

- UL标准 (UL Standard)**  
 1. 额定电压与电流: 300V/15A  
 Rated voltage/Rated current: 300V/15A  
 2. 功率耐压: AC1600V/Min  
 Withstanding Voltage: AC1600V/Min  
**IEC标准 (IEC Standard)**  
 1. 额定电压与电流: 320V/20A  
 Rated voltage/Rated current: 320V/20A

**NOTE 2:**

1. 间距 (Pitch): 5.00mm  
 2. 使用温度范围: -40℃~+105℃  
 Operating temperature: -40℃~+105℃  
 3. 符合RoHS环保要求  
 RoHS Compliance  
 5. 未标注公差表  
 Undimensioned tolerances

| 理论尺寸范围 (mm)       |        | 实际尺寸范围 (mm)                   |       |         |          |           |       |        | D |
|-------------------|--------|-------------------------------|-------|---------|----------|-----------|-------|--------|---|
| Pitch range in mm |        | Nominal dimension range in mm |       |         |          |           |       |        |   |
| ≤6                | 6 ~ 10 | 10 ~ 24                       | ≤30   | 30 ~ 60 | 60 ~ 100 | 100 ~ 150 | ≥150  | 0.1/10 |   |
| ±0.15             | ±0.20  | ±0.30                         | ±0.20 | ±0.30   | ±0.50    | ±0.70     | ±1.00 | ±1'    |   |

**订购方式 (HOW TO ORDER)**

**MX2EDGVM-5.00 □ □ P □ □ □ □ □ □ □ □**

型号 Series No.    间距 Pitch    极数 Poles    客户型号 Customer Request

- 颜色 (Color)**  
 1. 灰色 (Gray)    2. 蓝色 (Blue)  
 3. 黑色 (Black)    4. 绿色 (Green)  
 5. 橙色 (Orange)    6. 红色 (Red)  
 7. 黄色 (Yellow)    8. 白色 (White)  
 9. 透明 (Transparent)

N=No. of contacts

| ITEM | NAME OF PART    | MATERIAL           | NOTES          |
|------|-----------------|--------------------|----------------|
| 2    | (Pin header) 引脚 | (Copper alloy) 铜合金 | (Sn plated) 镀锡 |
| 1    | (Housing) 罩件    | PA66               | UL94V-0        |

|                        |   |
|------------------------|---|
| PART NO.:              | / |
| APPD:                  | / |
| CHKD:                  | / |
| DRFT:                  | / |
| THIRD ANGLE PROJECTION |   |

**宁波迈科思电子科技有限公司**  
 NINGBO MAX ELECTRONIC TECHNOLOGY CO.,LTD

|    |                   |
|----|-------------------|
| 型号 | MX2EDGVM-5.00-XXP |
| 系列 | MX2EDGVM-5.00     |
| 图号 | MX2EDGVM500001    |
| 页码 | 1/1               |
| 比例 | 1:1               |

8 7 6 5 4 3 2 1