

RoHS Compliant Customer Drawing

REV.	ECN NO.	DESCRIPTION	DATE	DESIGN

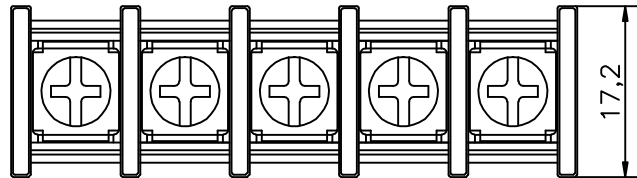

·材质及电镀(Material)  
 塑料(Housing): PA66, UL94V-0  
 端子(Terminal): 黄铜, 1.0t 镀锡(Brass, Tin plated)  
 螺丝(Screw): M4, 钢, 镀锌(Steel, Ni-Plated)

·电气性能(Electrical)  
 额定电压(Rated Voltage): 300V  
 额定电流(Rated Current): 25A  
 绝缘电阻(Insulation Resistance): 500MΩ/DC500V  
 耐电压(Withstanding Voltage): AC2000V/Min

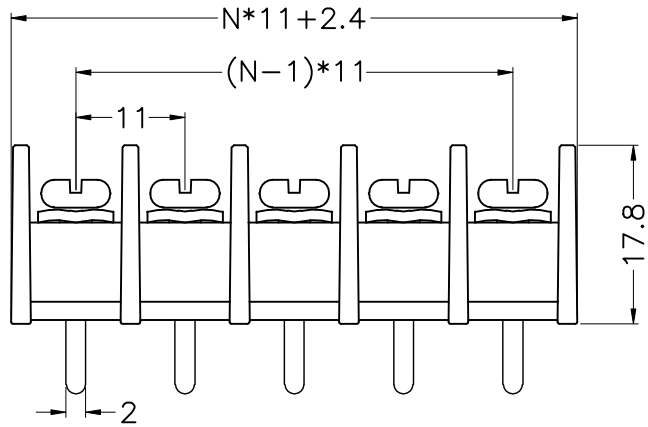

·机械性能(Mechanical)  
 温度范围(Temperature Range): -40℃~ +105℃  
 适用线径(Wire Range): 22-14AWG  
 最大扭矩值(Max.Torque Value): 0.5N.m 4.4Lb.in

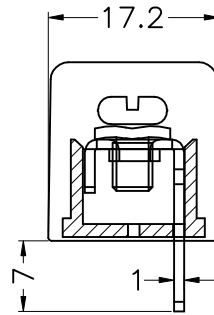

订购方式/HOW TO ORDER

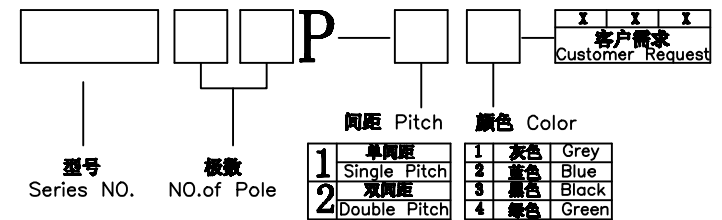

CONTACT WITH US:  
 TEL:+86-574-63505128 FAX:+86-574-63532183  
 E-Mail:sales@nbmax.com.cn Website:www.nbmax.com.cn

N=No. of contacts

公差一览表 TOLERANCE UNLESS OTHERWISE				宁波迈科思电子科技有限公司 NINGBO MKX ELECTRONIC TECHNOLOGY CO.,LTD					
X.	±0.25	X*	±5°	单位 UNITS	mm	制图 DRAWING	陈冬梅	产品名称 TITLE	MX65S-11.0
.X	±0.20	.X*	±2°	角法 VIEW		设计 DESIGN	顾兴伟	产品料号 PART NO.	MX65S-11.0
.XX	±0.15	.XX*	±1°	比例 SCALE	1:1	审核 CHKD		图号 DRAW NO.	MX65S-11.0-0A
.XXX	±0.02	.XXX*	±0.5°	日期 DATE	2012.07.10	版本 VER	A0	核准 APPD	